

PLAN CADASTRAL

UAT: Novaci, județul: GORJ, Sector cadastral 100, planșa 1
Scara 1:1000
Sistem de proiectie: stereografic 1970
Spre Publicare

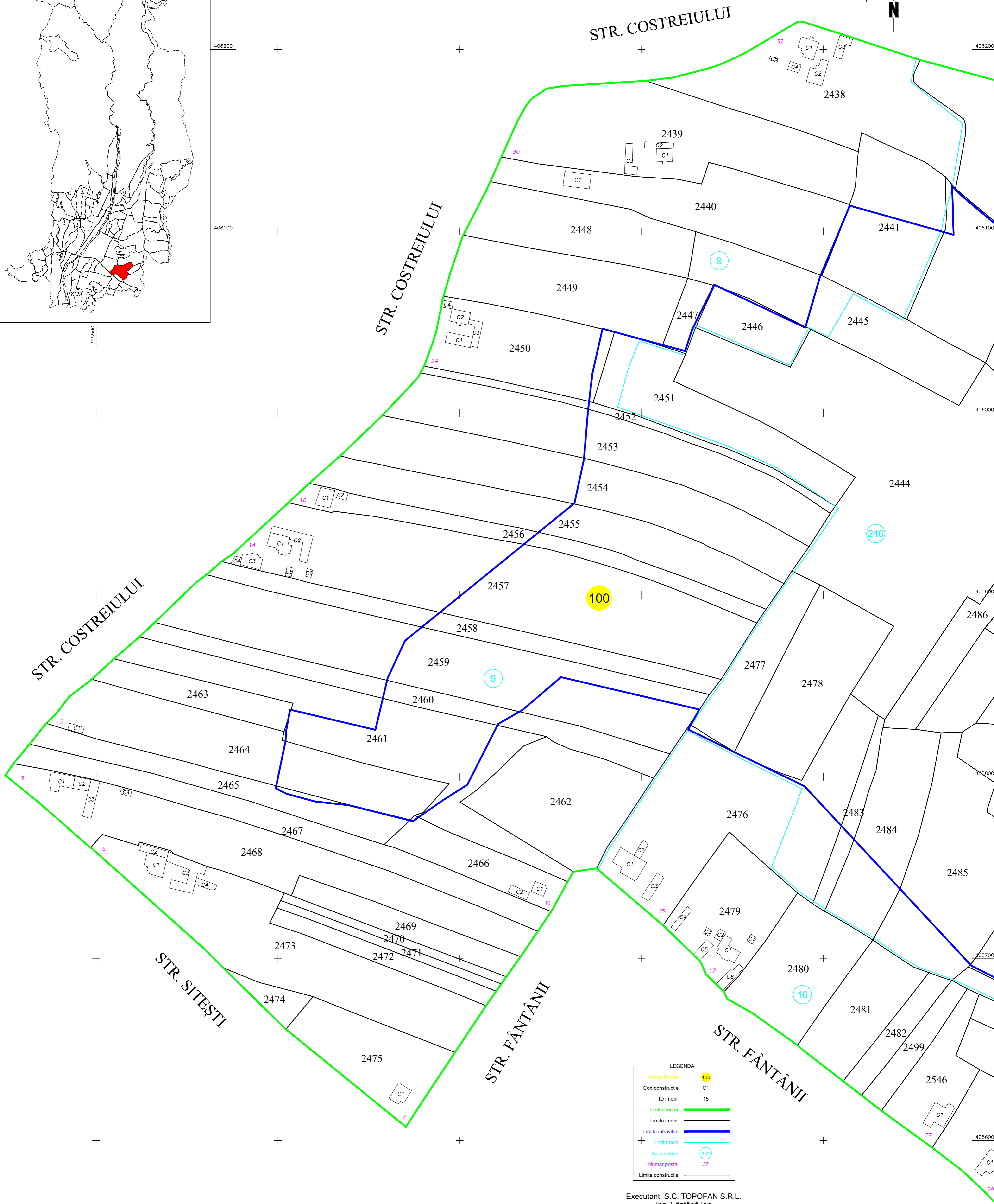
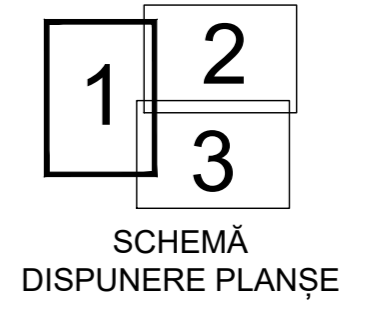

LEGENDA

Numar Sector	100
Cod constructie	C1
ID imobil	15
Limita sector	— (green line)
Limita imobil	— (black line)
Limita intravilan	— (blue line)
Limita tarla	— (cyan line)
Numar tarla	101
Numar postal	37
Limita constructie	— (black line)

Executant: S.C. TOPOFAN S.R.L.
Ing. Fântână Ion
Data: 19.08.2022

PLAN CADASTRAL
UAT: Novaci, judetul: GORJ, Sector cadastral 100, plansa 2
Scara 1:1000
Sistem de proiectie: stereografic 1970
Spre Publicare

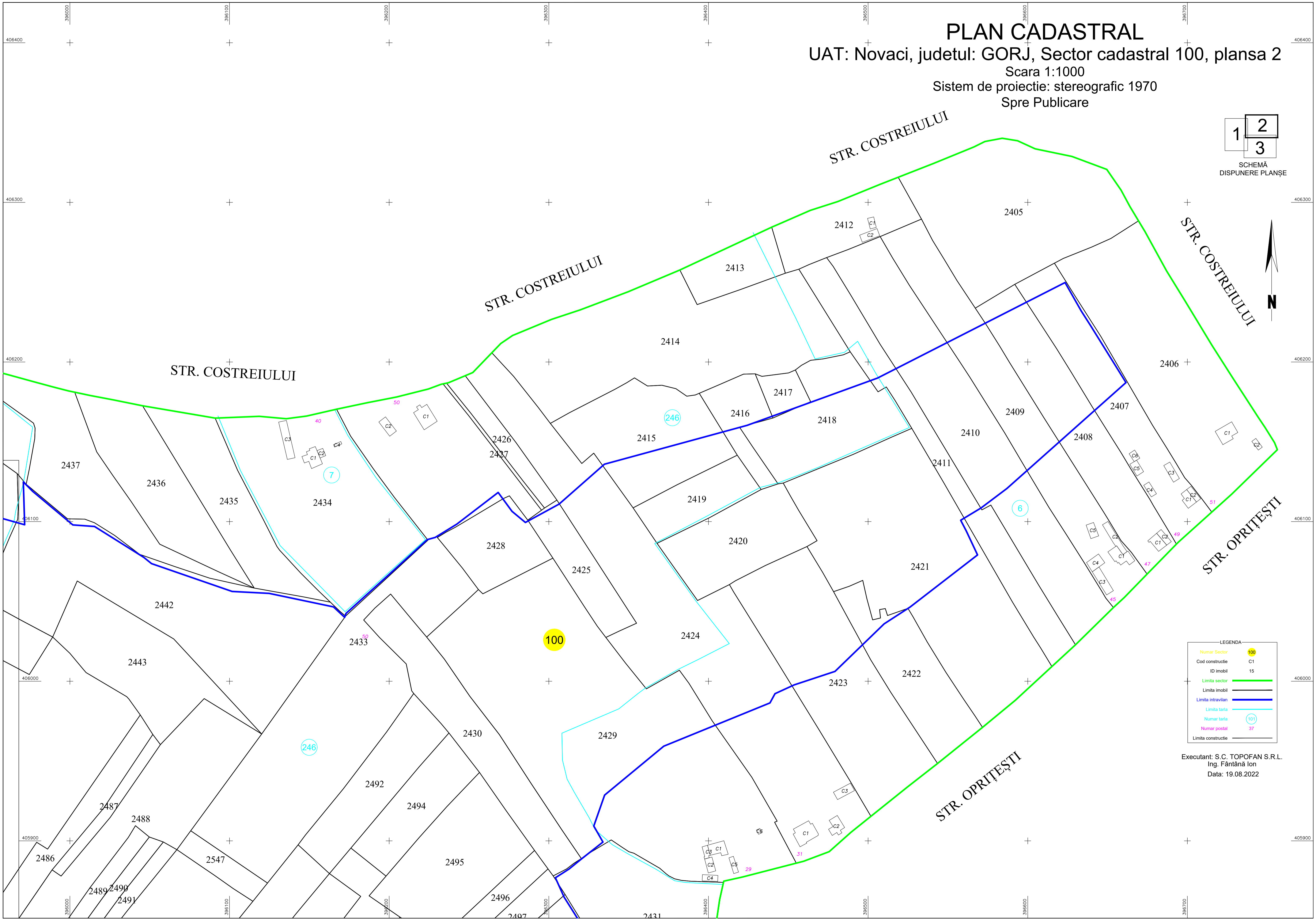
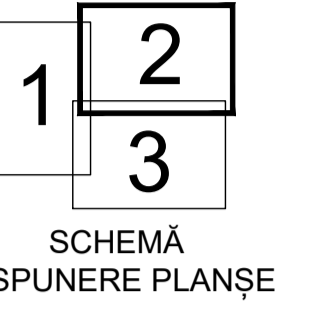

LEGENDA

Numar Sector	100
Cod constructie	C1
ID imobil	15
Limita sector	— (green line)
Limita imobil	— (black line)
Limita intravilan	— (blue line)
Limita tarla	— (cyan line)
Numar tarla	101
Numar postal	37
Limita constructie	— (black line)

Executant: S.C. TOPOFAN S.R.L.
Ing. Fântână Ion
Data: 19.08.2022

PLAN CADASTRAL

UAT: Novaci, judetul: GORJ, Sector cadastral 100, plansa 3

Scara 1:1000

Sistem de proiectie: stereografic 1970

Spre Publicare

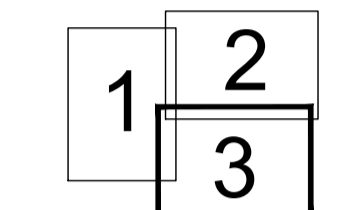

SCHEMĂ
DISPUNERE PLANȘE



N

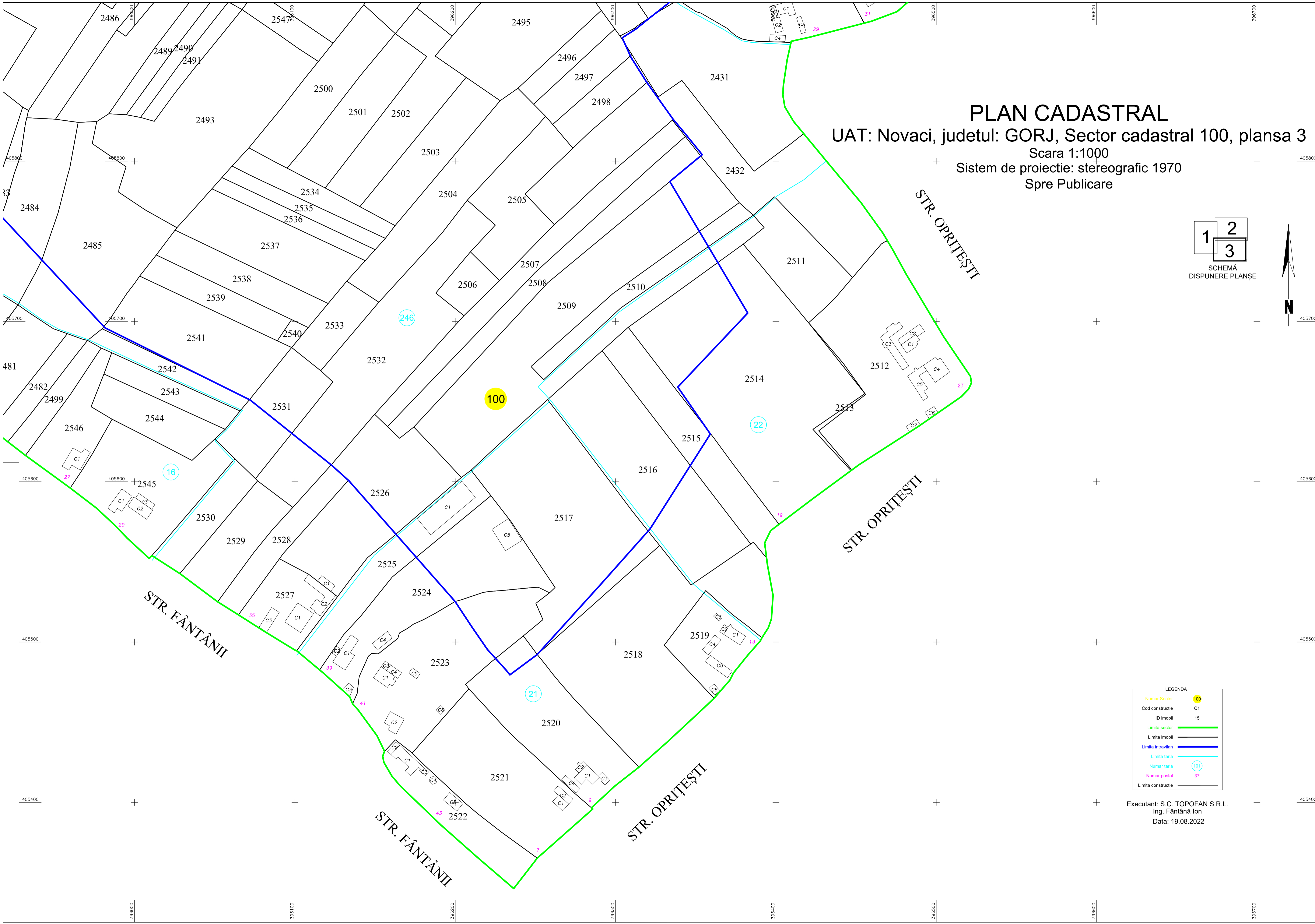

LEGENDA	
Numar Sector	100
Cod constructie	C1
ID imobil	15
Limita sector	— (green line)
Limita imobil	— (black line)
Limita intravilan	— (blue line)
Limita tarla	— (cyan line)
Numar tarla	101
Numar postal	37
Limita constructie	— (black line)

Executant: S.C. TOPOFAN S.R.L.
Ing. Fântână Ion
Data: 19.08.2022